

Installation Instructions

GEMINI G9 PHOTOVOLTAIC RACKING SYSTEM



DISTRIBUTED BY:
RENEWABLE SALES
16 EVERETT ST HOLLISTON MA 01746
508-309-4437 INFO@RENEWABLESALES.COM

GEMINI G9 PV RACKING SYSTEM

INSTALLATION INSTRUCTIONS

1. SETTING THE FIRST FOUNDATION IN A PAIR

- a. SET THE G9 FOUNDATIONS PER CONSTRUCTION DRAWINGS. FOUNDATIONS HAVE (4) $\frac{1}{2}$ "-13 THREADED ATTACHMENT INSERTS EMBEDDED IN THE FOUNDATION CONCRETE. ORIENT THE FOUNDATION SO THAT THE END OF THE FOUNDATION WITH THE ATTACHMENTS 11" FROM THE END OF FOUNDATION IS POINTING SOUTH (FIGURE 1).

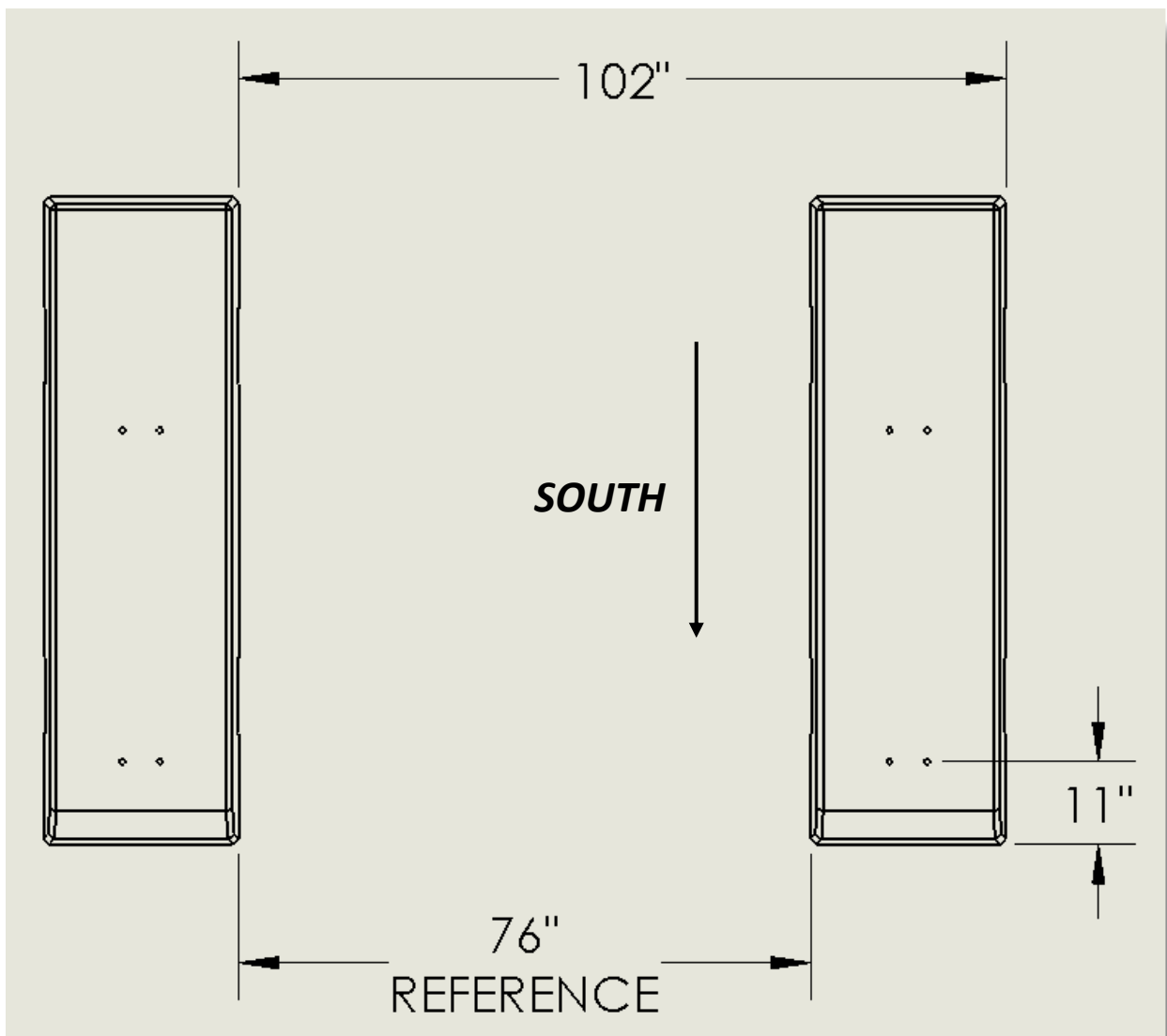

Figure 1

2. SETTING THE TRUSSES ON THE FOUNDATIONS

- a. REFERRING TO FIGURES 2 AND 3, SET A GEMINI TRUSS ON TOP OF EACH FOUNDATION. ORIENT THE TRUSS SO THAT THE HIGH POINT IS ON THE NORTH END. BOLT DOWN EACH TRUSS WITH (4) ½"-13 BOLTS AND THE HARDWARE SHOW IN TABLE 1.

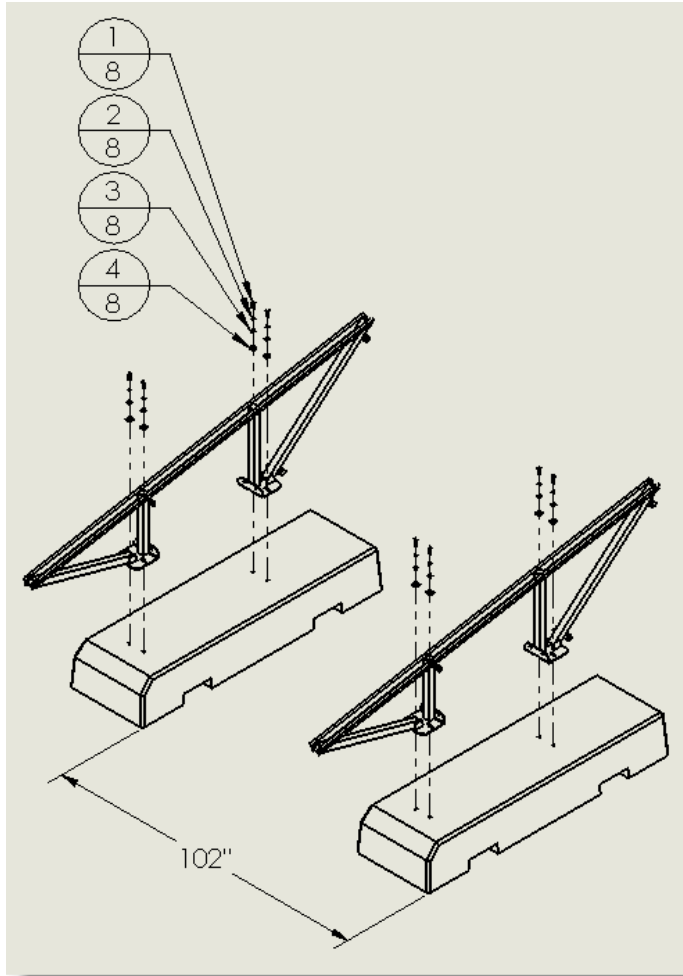

Figure 2

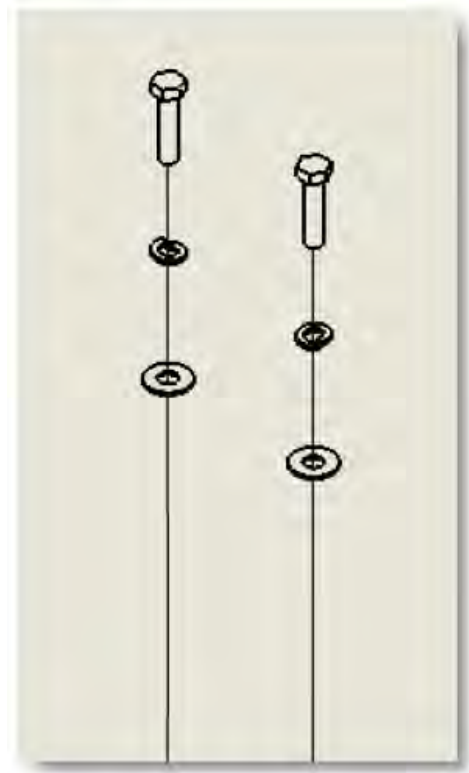

Figure 3

Table 1

ITEM NO.	QTY.	DESCRIPTION
1	8	BOLT, HEX, 1/2" x 2"
2	8	WASHER, SPLIT LOCK, 1/2"
3	8	WASHER, 1-1/4" x .08" THICK

3. INSTALLING THE CROSS SUPPORTS ON THE TRUSSES

- a. REFERRING TO FIGURE 4 AND TABLE 2, SECURE THE (2) NORTH AND (2) SOUTH CROSS SUPPORTS USING THE HEX BOLTS AND FLANGE NUTS (SEE DETAILS A AND B). DO **NOT** TIGHTEN ANY OF THE LOCK NUTS AT THIS TIME.

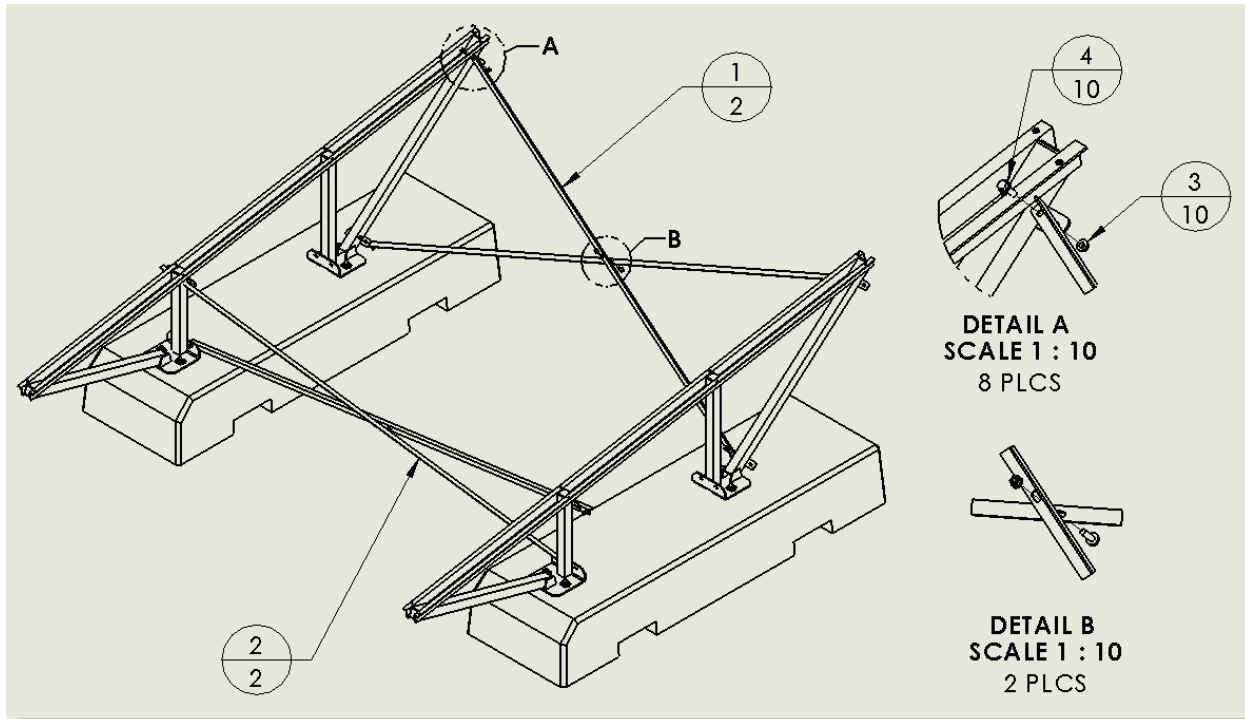

Figure 4

Table 2

ITEM NO.	QTY.	DESCRIPTION
1	2	CROSS SUPPORT, NORTH, G9
2	2	CROSS SUPPORT, SOUTH, G9
3	10	NUT, FLANGE, LOCKING, 3/8"
4	10	BOLT, FLANGE, HEX, 3/8" x 1-1/4"

4. ATTACHING MAIN CHANNELS TO THE TRUSSES

- a. SET THE (4) MAIN CHANNELS ACROSS THE TRUSSES. SEE FIGURE 5. USE THE HARDWARE SHOWN IN TABLE 3. WHEN THE CHANNELS ARE ALL ASSEMBLED TO THE TRUSSES, YOU MUST TIGHTEN **ALL** LOCK NUTS, INCLUDING THE CROSS SUPPORT LOCK NUTS. THE ASSEMBLY SHOULD NOW LOOK LIKE FIGURE 6.

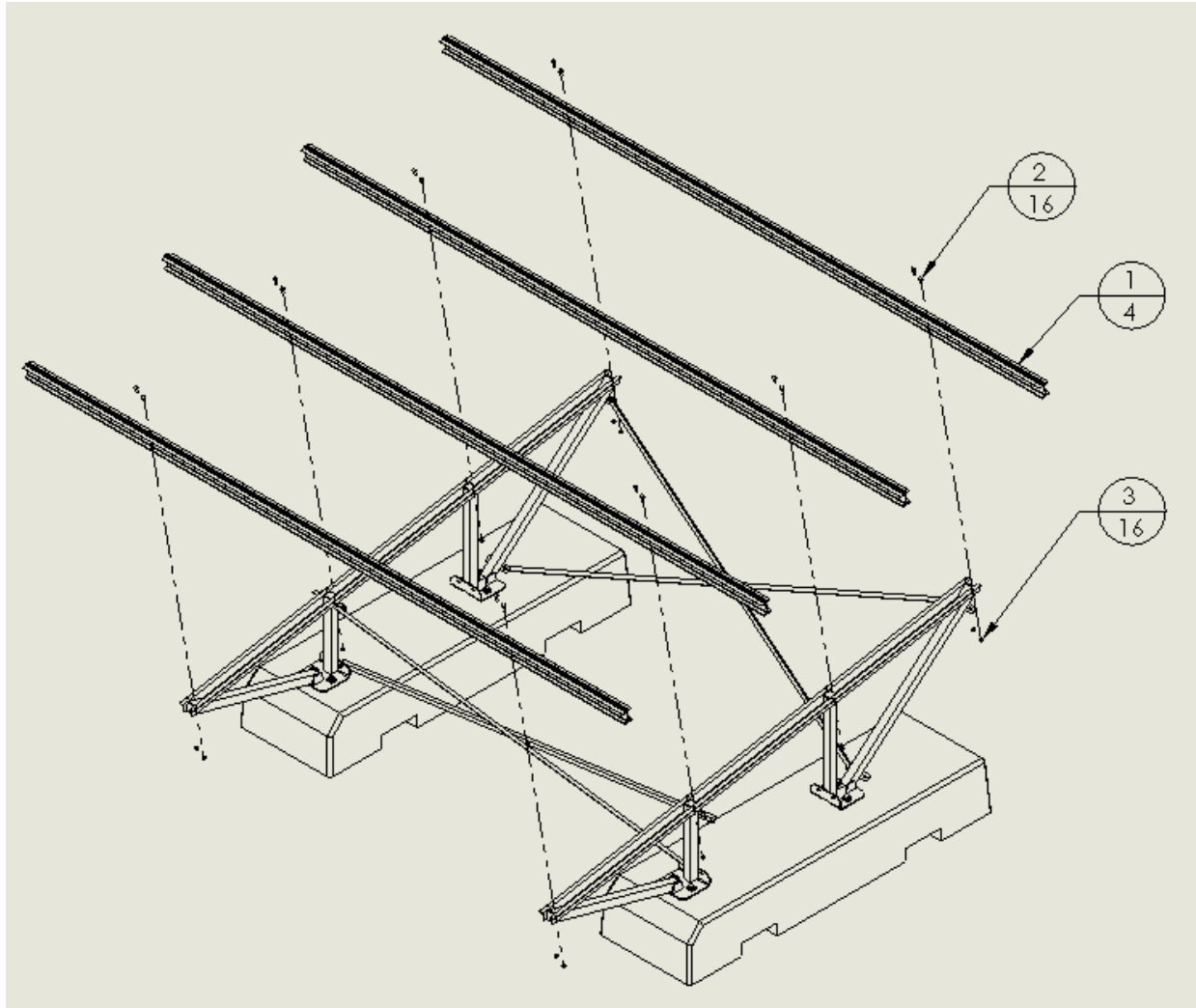

Figure 5

Table 3

ITEM NO.	QTY.	DESCRIPTION
1	4	CHANNEL, I1, MAIN, 170"
2	16	BOLT, FLANGE, HEX, 3/8" x 1-1/4"
3	16	NUT, FLANGE, LOCKING, 3/8"

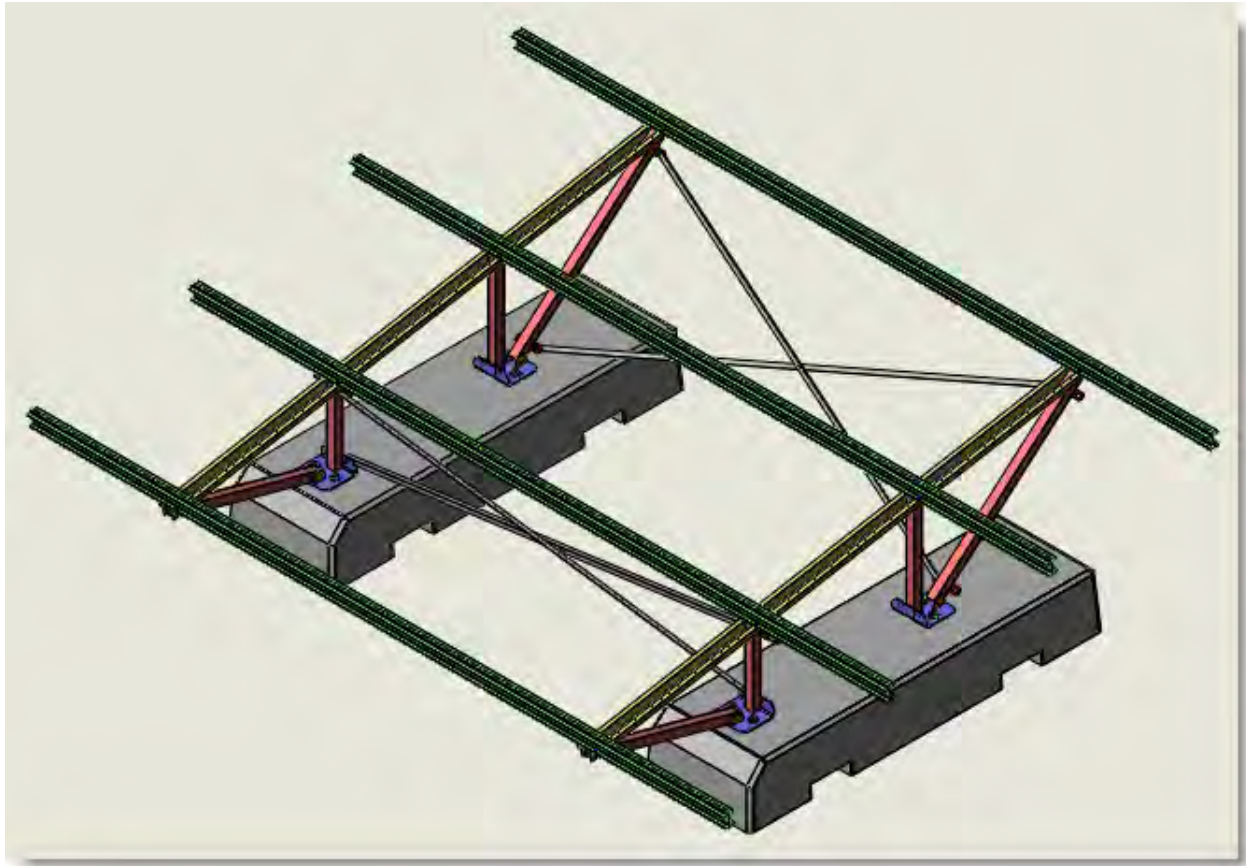

Figure 6

5. INSTALLING THE PV PANELS

- a. STARTING WITH THE CENTER PANEL IN THE MIDDLE, LOCATE THE PV PANELS ON THE RACK. SEE FIGURE 7.

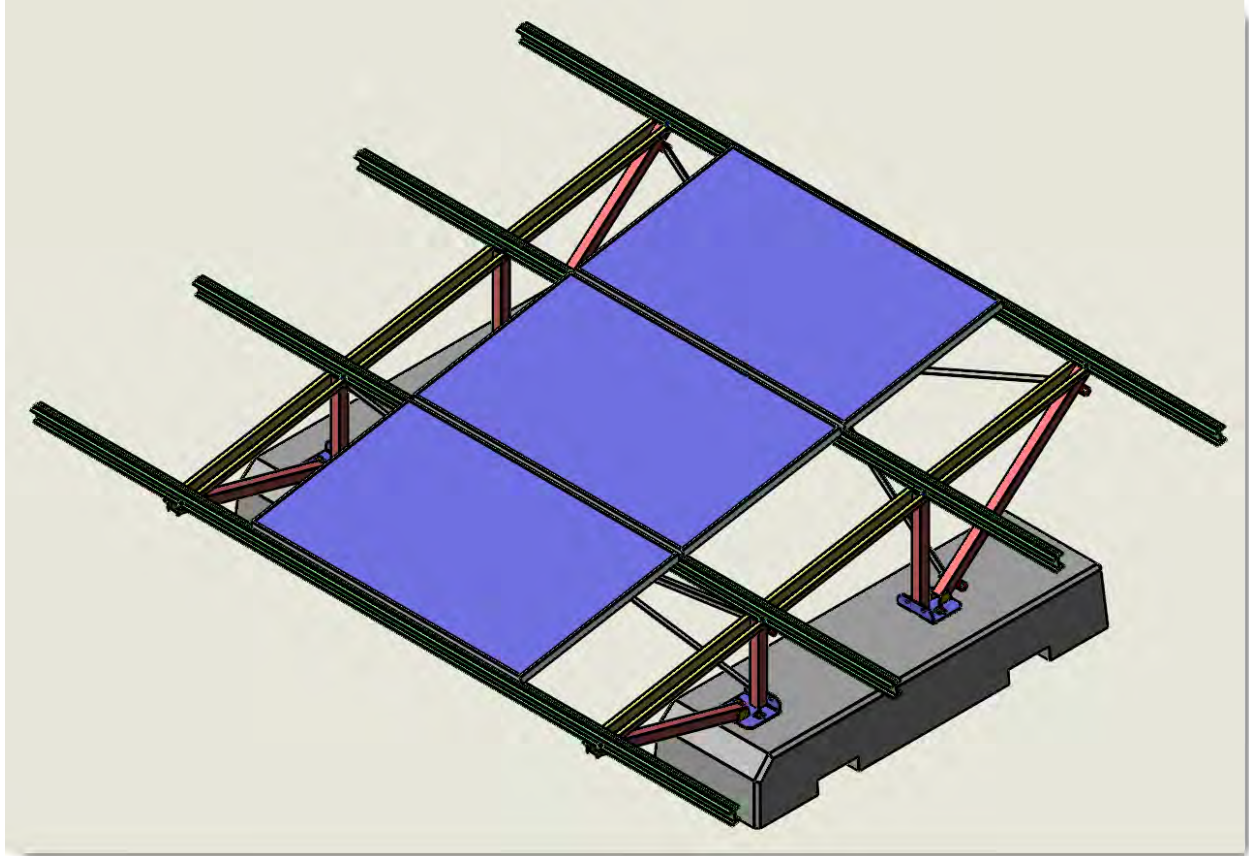

Figure 7

- b. HOLD THE PANELS IN PLACE USING THE CLAMPS LISTED IN TABLE 4. LOCATE THEM APPROXIMATELY AS SHOWN. THERE ARE TWO TYPES OF HOLDING CLAMPS, "H-TYPE" AND "END". THE H-TYPE CLAMPS ARE PUT INTO THE TWO CENTER MAIN CHANNELS. THE END CLAMPS ARE PUT INTO THE TOP AND BOTTOM MAIN CHANNELS. FIGURE 8 SHOWS WHERE THE CLAMPS WILL BE SET LEFT-TO-RIGHT IN THE CHANNELS. ALSO REFER TO FIGURES 9, 10 AND 11.

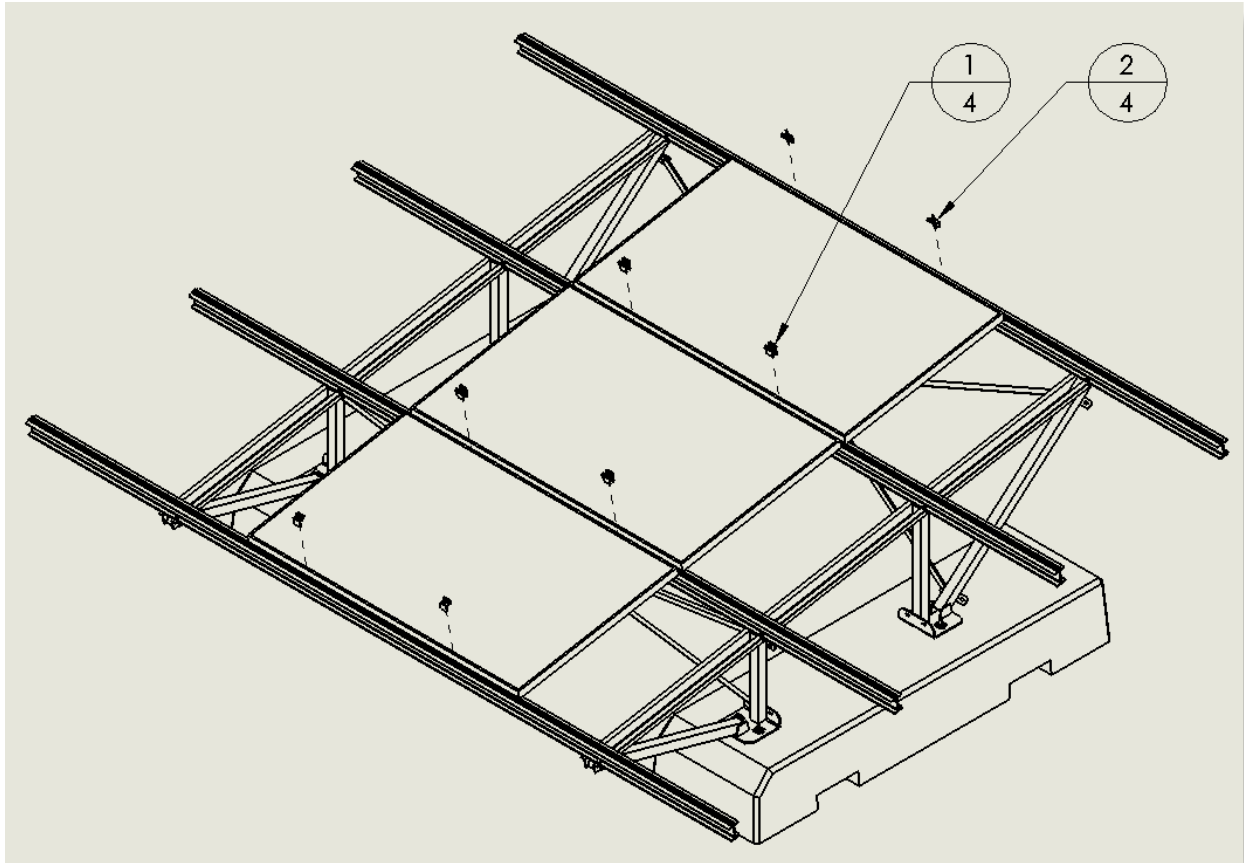

Figure 8

Table 4

ITEM NO.	QTY.	DESCRIPTION
1	4	CLAMP, H-TYPE, 1" x 1-1/2" x .450", UR BOLT 1/4 x 2-1/2"
2	4	CLAMP, END, 1" x 1-1/2" x .450", UR BOLT 1/4 x 2-1/2"

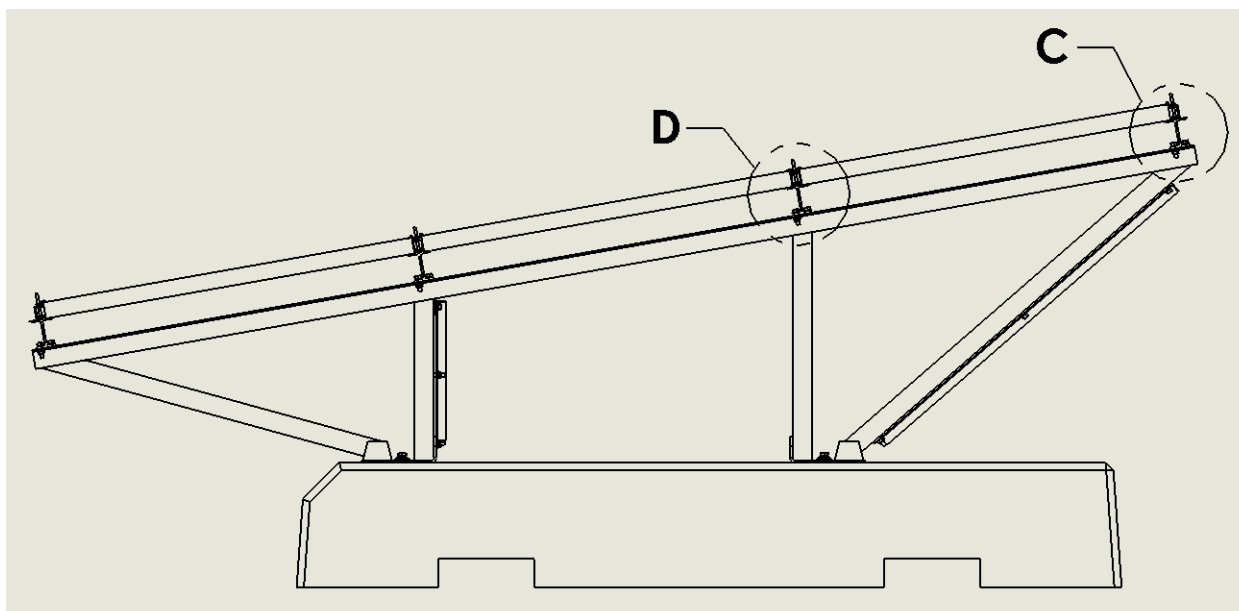

Figure 9

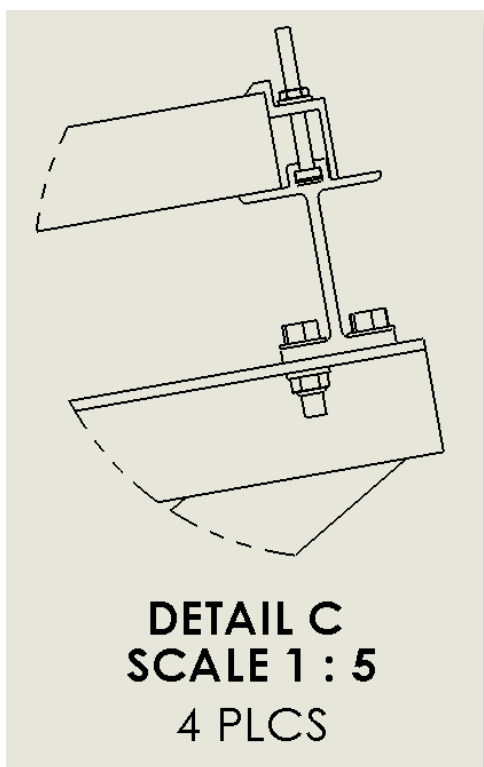

Figure 10

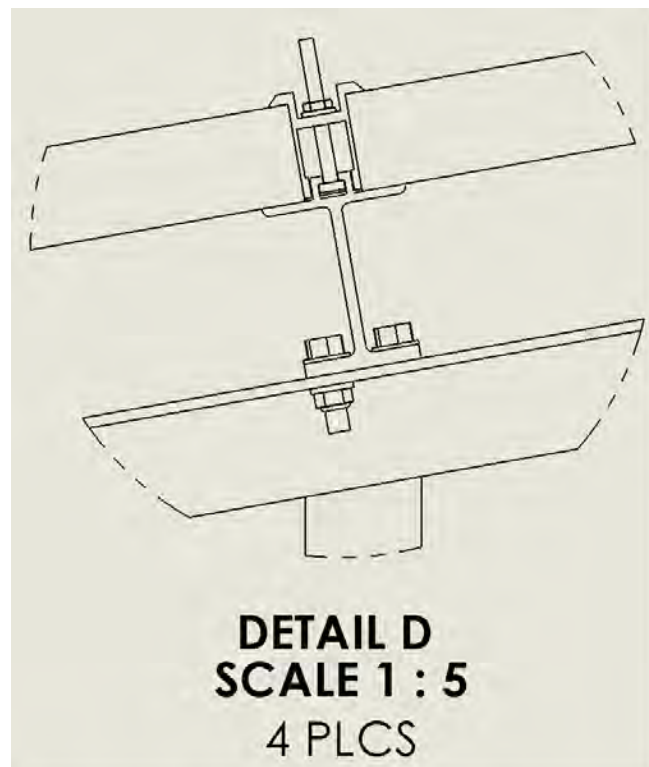

Figure 11

- c. CONTINUE TO INSTALL THE REST OF THE PV PANELS ON THE LEFT AND RIGHT SIDES OF THE RACK. AGAIN, USE THE CLAMPS LISTED IN TABLE 5 TO HOLD THE PANELS IN PLACE. REFERENCE FIGURE 12. THE ASSEMBLED RACK WITH PANELS WILL LOOK LIKE FIGURE 13.

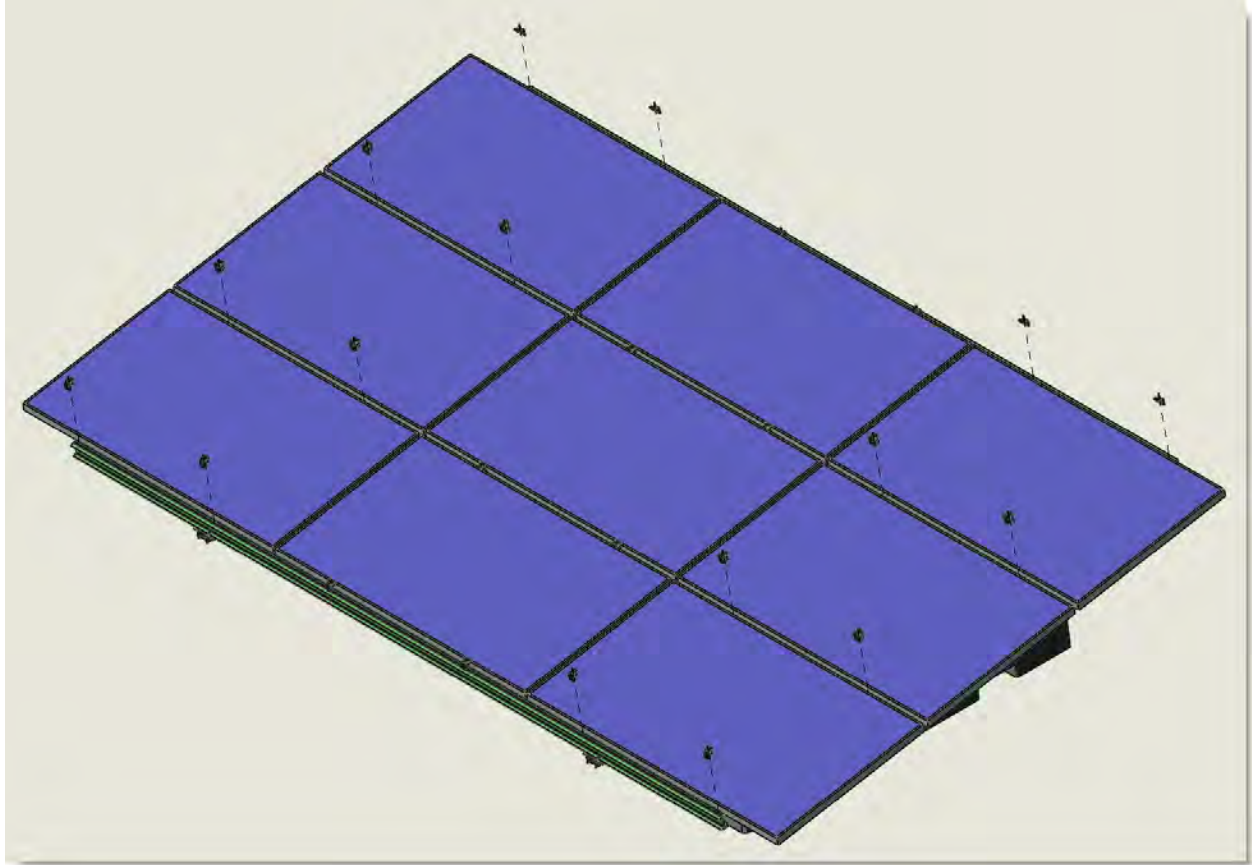

Figure 12

Table 5

ITEM NO.	QTY.	DESCRIPTION
1	8	CLAMP, H-TYPE, 1" x 1-1/2" x .450", UR BOLT 1/4 x 2-1/2"
2	8	CLAMP, END, 1" x 1-1/2" x .450", UR BOLT 1/4 x 2-1/2"

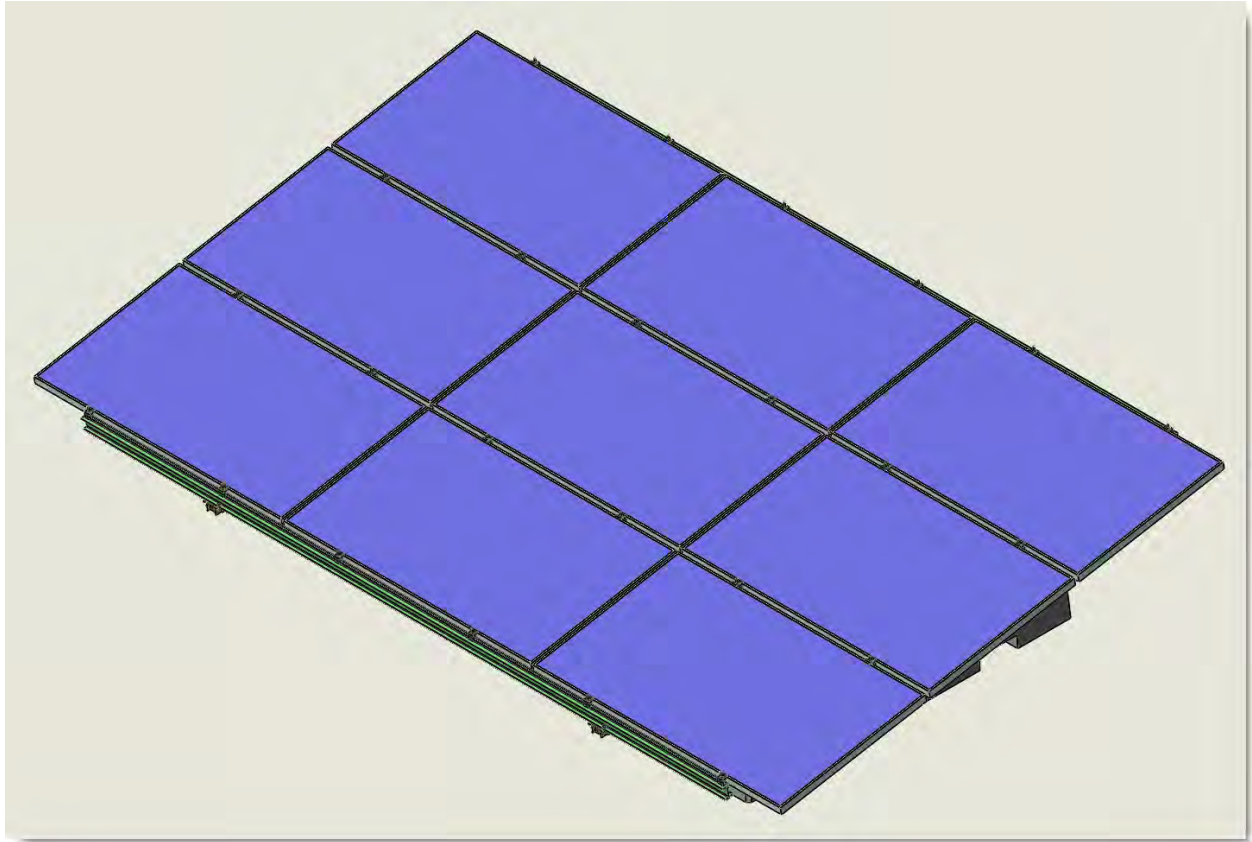

Figure 13

THIS COMPLETES THE MOUNTING SYSTEM ASSEMBLY. **BE SURE TO TIGHTEN ALL BOLTS AND LOCKNUTS.**